

616 Te Ngae RD ~~83~~ ²⁰²⁵¹ ~~1127~~ Street Lot ~~83~~ DPS ~~1127~~ Section Block

ROTORUA DISTRICT COUNCIL

Drainage to Sewer (8262)

Owner: Mrs McDonald

Plumber:

Drainlayer: J Davis

Valuation No.: 6993/401

Permit No.: 11667

Appn. No.: 249

Date: 5-8-85

INSPECTIONS

Date 6-8-85

Drains inspected & tested PVC (water test)
Job complete.



Application No. 249

ROTORUA DISTRICT COUNCIL

Valuation No. 6993 / 401

APPLICATION FOR PERMIT TO CARRY OUT SANITARY PLUMBING AND DRAINAGE WORK

I, the undersigned, hereby apply for permission to have the work described herein, and set out on the plans attached hereto, carried out in accordance with the provisions of the Drainage and Plumbing Regulations 1978 and Amendments at premises situated at:

Address 616 TE NGAE RD.

Legal Description:

Lot No. 88 Deposited Plan No. 1127

Section No. _____ Block No. _____

Description of Work: CONNECT RES TO SEWER.

Name and address of person for whom work is to be carried out:

McDONALD. 616 TE NGAE RD.

Name and address of Craftsman Plumber: _____

Name and address of Registered Drainlayer: _____

JOHNS
52 CORRETT ST.

	Value	Fees
Plumbing	\$:	\$:
Drainage	\$ 90 :	\$:
TOTAL FEES		\$ 20 :

Signature: _____

Date: 5/8/85

FOR OFFICE USE ONLY

Receipt Number 3

Fee Paid \$20.00

Date Paid 5-8-85

Issue Approved [Signature]

Date Approved 5/8/85

Permit No. 11667

See reverse for Fees and Notes

FOR OFFICE USE ONLY

FEES PAYABLE ON THE ISSUE OF ANY PLUMBING OR DRAINAGE PERMIT

according to the Estimated Value of Work

Value of work (excluding value of fittings)		
Value of Work		Permit Fee
Up to \$50		\$15
\$51 - \$100		\$20
\$101 - \$200		\$32
\$201 - \$300		\$38
\$301 - \$400		\$44
\$401 - \$500		\$50
\$501 - \$600		\$56
\$601 - \$700		\$62
\$701 - \$800		\$68
\$801 - \$900		\$75
\$901 - \$1000		\$80

\$1001 and over, \$7 extra for every \$200 or part thereof in excess of \$1000

IMPORTANT

INSPECTION AND TESTING REQUIREMENTS

DRAINAGE WORK: Drainlayers are required to notify the Plumbing and Drainage Inspector when all work is completed. This includes **effluent disposal** systems for septic tanks. All drains will be tested with a 1.5 m head of **water**. To implement this test it will be necessary for persons undertaking drainage work to **have sufficient** drain plugs to fill all sections of the drain prior to the Plumbing and Drainage Inspector arriving on the job, also to have available a stand pipe to apply the 1.5 m head pressure.

This form of testing is essential to exclude the possibility of ground water infiltration with its attendant increase in pumping charges and overloading of the sewers and treatment plant.

PLUMBING WORK: Plumbers are required to notify the Plumbing and Drainage Inspector when work is ready for inspection as follows:

- (a) When the building has been initially piped out and wastes are installed (before wall linings are fixed and floors laid).
- (b) When work is complete.

Plans of Drainage and Plumbing Work

In the case of single houses a preliminary drainage plan will not be required. In all other cases, however, plans of the preliminary proposal are to be submitted at the time of application for a permit. In all instances, however, an "as laid" plan must be available on site as a prerequisite to a test of the work.

In commercial buildings full plans and elevations of plumbing stacks must be provided at the time of application for a permit.

Plans **MUST** show dimensions and distances from section boundaries in metric units

Rotorua District Council

DRAINAGE PLAN

NEW SEWERAGE DRAINS—RED
STORMWATER—DOTTED BLACK
OLD DRAINS—FULL BLACK

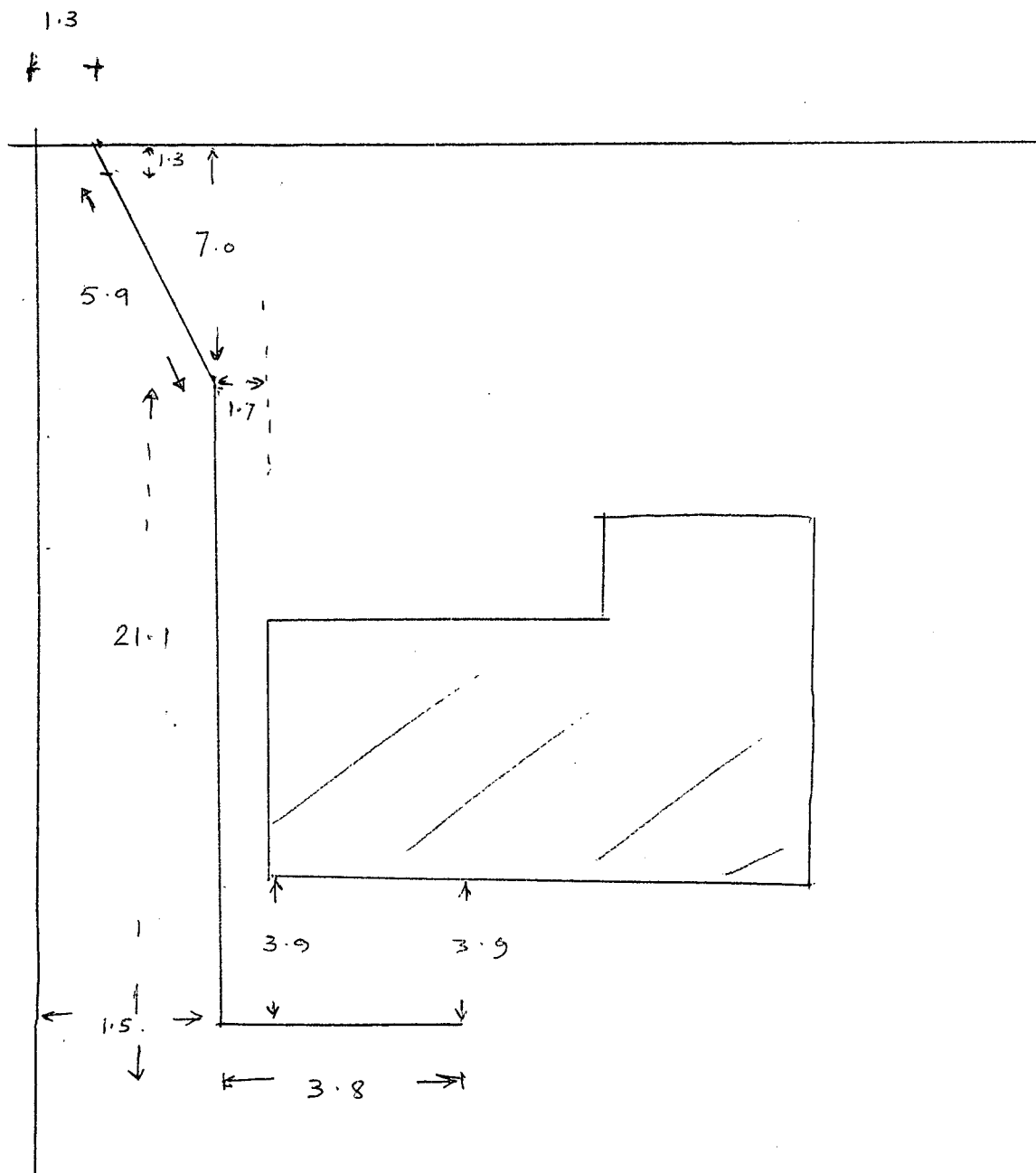

OWNER

McDonald.

No.

616

STREET

TE NGAE

LOT

38.

SEC.

BL.

SIGNATURE
OF DRAINLAYER

James

DATE

6/8/83.